

INNO-EXFL

EXCESS FLOW VALVES

**QUALITY MADE
IN GERMANY**

Excess Flow or Line Rupture Valves Range:

- Design acc. ASME B16.34, AD2000 or others
- ½" - 36" CI 150 – 2500 (others on request)
- Double Flanged or Wafer Type (others on request)
- Materials: Carbon, Stainless, Inconel, Hastelloy, Duplex, Monel and other materials as per customer request
- For Liquid, Gas or Vapor Service
- Custom made designs and trim options pending application details
- Special Classes or Sizes and Special Design features on request

Features:

- Spring Loaded in line Check Valves that are kept in open position and will close when the flow through the valve exceeds a predetermined flow
- Closing flow rates are determined by customer

During normal operation Excess Flow Valves allow flow in either direction. Once the valve is closed pressure on inlet and outlet is required to be equalized for re-setting. This can be done via an equalizing hole in the seat or an external by-pass where possible by the valve design

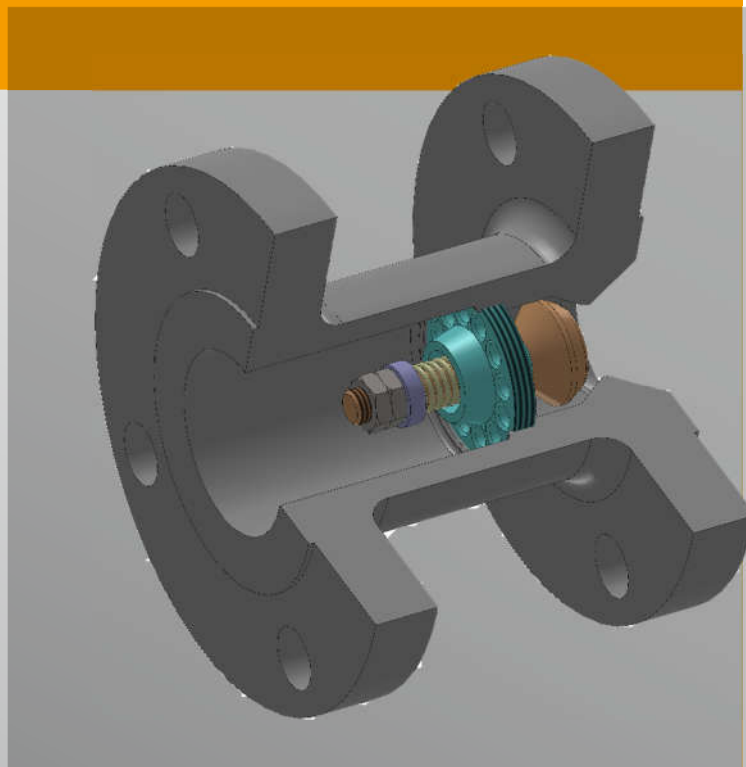

Applications:

Refinery, Petrochemical, Gas, Chemical,
Power, Tank Farms and others

Trim Parts
INNO-EXFL Valves



MIAM is designing, producing and testing its valves in Magdeburg Germany. Quality and customer focused designs are core values at MIAM.

A highly experienced design staff is able to custom design to meet and exceed the customers expectations

Contact us for more information!